

# Econocheck Underscreed XL5 system

Issue 2 • April 2011

FOR NEW BUILD AND CONVERSIONS

One of the **isomass**  
Econocheck range

The Econocheck Underscreed XL5 system from Isomass features a 5mm closed cell cross linked foam layer that has been designed to be placed within a masonry structural floor directly below the screed. This serves to isolate the screed from the structural sub floor, and provide sufficient impact absorption to place it amongst the top performing systems available today.

By ensuring that all the joints are taped, bridging will be eliminated which is the single greatest cause of failure of any system of this type.

When installed correctly, the Econocheck Underscreed system will enable compliance with Approved Document E 2003 and subsequent amendments in 2004.

## Product data

Roll dimensions:	50m long x 2.0m wide
Thickness:	5mm
Foam composition:	Closed Cell Cross Linked Isopoli

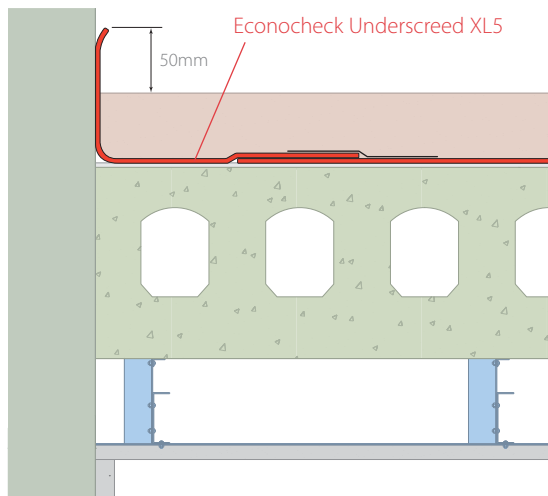

- 80kg/m<sup>2</sup> sand/cement screed or 65mm proprietary screed.
- Econocheck Underscreed XL5 on grouted sub floor.
- ≥300kg/m<sup>2</sup> minimum structural sub floor.
- 75mm min. void formed by metal frame suspended ceiling system and ≥10kg/m<sup>2</sup> gypsum board ceiling.

## Performance (on the construction above)

Treated floor with:	$D_{nT,w} + C_{tr}$	$L'_{nT,w}$
Econocheck XL5	50dB	45dB

Every effort has been taken in the preparation of this sheet to ensure the accuracy of representations contained herein. Recommendations as to the use of materials, construction details and methods of installation are given in good faith and relate to typical situations. However, every site has different characteristics and reliance should not be placed upon the foregoing recommendations. Advice can be given as to specific applications of the products, upon request to isomass building products.

## BENEFITS

- Closed cells prevents water absorption which can impair acoustic performance.
- Rolls are light and easy to handle.
- All installations over 500m<sup>2</sup> come with a free site pre screed inspection.

## INSTALLATION

- The floor surface should be swept free of any loose debris that may damage or bridge the system.
- Econocheck XL5 can be rolled up the wall or lapped and taped to a perimeter flanking strip. Either option should allow a minimum 50mm to protrude above the intended FFL of the screed.

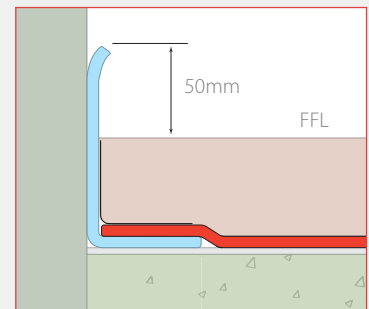

- Adjoining roll edges should be jointed and sealed with a minimum 100mm wide jointing tape.
- Services that penetrate the screed should be isolated by wrapping with Underscreed which again would be taped.
- When trafficking the floor take care not to perform any unnecessary actions that may cause any of the taped joints to be forced apart.

## Technical enquiries

Tel: **0845 838 33 99**

Fax: **0845 838 33 89**

Email: [info@isomass.co.uk](mailto:info@isomass.co.uk)

[www.isomass.co.uk](http://www.isomass.co.uk)

