

The Isocheck Maximo system (for timber floors)

LAYING & FIXING INSTRUCTIONS

SITE CONDITIONS

Before commencing please ensure that all recessed down-lights or other invasive fittings have been correctly treated prior to closing off the sub-floor from above with the **Isocheck** system. If not confirmed to be of a solid construction all structural walls should be sealed both top and bottom prior to floor laying. e.g.: lath & plaster wall linings, dot & dab systems, 'hollow' battened skirting, etc. **IF IN DOUBT, PLEASE CALL ISOMASS PRIOR TO COMMENCEMENT OF WORK FOR ADVICE**

The following additional guidance should also be noted before the installation of the **Isocheck** system. Please contact us should you wish to deviate for additional advice.

1/ Sub Floor

The floor void between the joists should be swept free of debris. All nails and screws on top of the joists removed or driven flush to leave a smooth continuous dry surface to receive the system. Any associated work to level joists should also be done at this time. It is advisable that any new ceiling installation be installed prior to laying of the floor together with a continuous layer of 100mm (45kg/m³) mineral fibre insulation between the joists. Where applicable resilient bars should be installed perpendicular to the joist direction at the manufacturers recommended centres which are typically 400mm.

2/ Laying timescale

Installation of **Isocheck Maximo** can commence before the roof, window glazing and wet trades are completed providing all joints are glued with D4 adhesive on both the top of the tongue and bottom of the groove of every joint. Leave overnight for adhesive to cure before trafficking this newly installed system.

3/ Care of Materials

Isocheck Maximo must be kept in a dry storage area. Deliveries should be scheduled to coincide with availability of suitable dry storage areas.

INSTALLATION

To commence installation, fitting should begin at the furthest point from the entrance and marked out so as not to finish with any panels less than 200mm wide. The decking must be laid in 'stretcher-bond' pattern, with all joints glued and staggered See **Fig. 1**. All edges of the boards where they meet the walls should receive continuous support even between the joists. No Mechanical fixings should be used. **Isocheck** adhesive should be applied to both the top of the tongue and the bottom of the groove on each side of each joint. The boards are then pushed tightly together. Surplus adhesive should be wiped away from the surface with a damp cloth.

FLANKING STRIPS

Isocheck flanking strips provide isolation of the flooring system from all vertical structures and penetrations. The strip is trapped to the wall and returned down over the **Isocheck**. The skirting board is then fixed to the wall securing the flanking strip between the skirting board and the **Isocheck**. After the skirting board is installed, simply trim the flanking strip flush with a sharp knife "please do not remove". See **Fig. 2**.

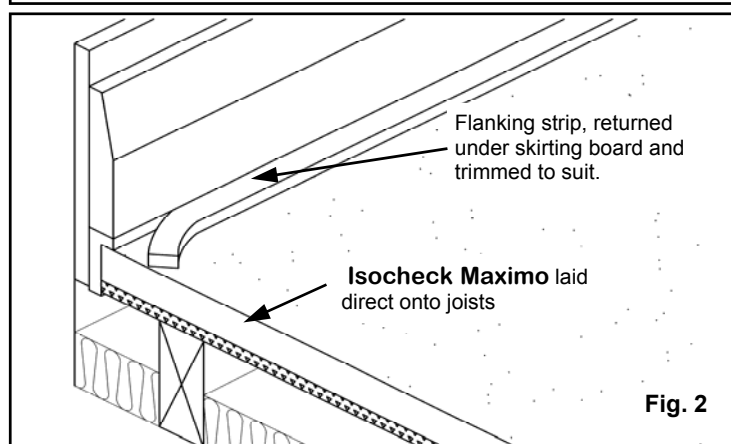
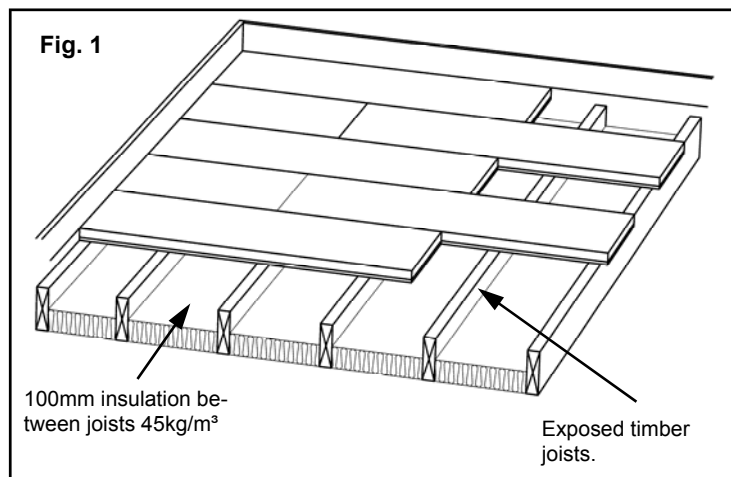

Issue: 1

Sheet 1 of 2

Isomass Ltd

St Johns Innovation Centre, Cowley Road,
Cambridge, CB4 0WS
T: 0845 838 33 99
F: 0845 838 33 89
E: technical@isomass.co.uk W: www.isomass.co.uk

The **Isocheck Maximo** system (for timber floors)

LAYING & FIXING INSTRUCTIONS continued

STUD PARTITIONING

Ideally stud partitioning should be built from the joists which should ideally be isolated as much as possible. If it is your intention to build off the top of **Isocheck Maximo** additional advice should be sought before you start. All partitions built from the sub-floor will require **Isocheck** flanking strip installed to the partition and additional support each side of the sole plate where the **Maximo** is terminated.

DOOR OPENINGS / ARCHITRAVES / SKIRTINGS

Door openings should have linings fitted prior to the installation of the acoustic floor. Boards should be carefully detailed to ensure a good fit. Although not ideal architraves and stops can be fixed after floor installation, leaving a 2/3mm gap from the surface of the floor.

To prevent flanking transmission **all** skirting must be isolated from the floating floor surface. See **Fig. 2**.

Before incorporation, place flanking strip around the edge of the **Isocheck** board before pushing in position. Remove any excess with a sharp knife, flush to the skirting face.

CEILINGS

All new ceiling boards should be installed first, especially before any dry-lining of walls (such as dot & dab) to prevent potential flanking transmission. Ceilings should be boarded to provide a minimum mass of 20kg/m², which can be enhanced for additional acoustic performance when supported by resilient bars or suspended from a MF system.

KITCHENS & BATHROOMS

Appliances and sanitary ware, with rigid plumbing connections that penetrate the system, should be isolated from the floating floor by cutting a hole up to 10mm larger than the service diameter and filling the gap with an acoustic sealant. Ideally kitchen worktops should be isolated from the wall with a Flanking isolation strip and trimmed flush with surface before tiling commences.

When laying **Isocheck Maximo** in a kitchen or bathroom it is essential that additional support noggins are placed between the joists as well as the perimeter support referred to previously. This is to support the higher loads imposed on the floor in specific areas. If in doubt as to the configuration or qty of support noggins additional advice should be sought to reduce the potential for undue deflection in these potentially high load areas.

PROTECTION

The finished **Isocheck Maximo** system should be protected with an appropriate layer immediately after being installed to prevent damage by any following tradesmen. It is advisable to protect the floor surface from any damage by following trades as in most cases this is the last floor component that remains an integral part of the structure.

Health and Safety

HANDLING

Isocheck boards are **HEAVY**. Please observe proper lifting methods and if transporting around site, by hand. Care should also be taken to protect hands from splinters during manual handling.

CUTTING

The cutting of boards, either by hand or machine, will produce dust that may be an irritant if inhaled. **USE** dust masks when carrying out any cutting operations

STORAGE

The foam resilient layer, on **Isocheck** is manufactured using latex. The boards should therefore be stored in safe dry areas and kept away from naked flames. **NO SMOKING** policies must be strictly enforced.

Issue: 1

Sheet 2 of 2

Isomass Ltd

St Johns Innovation Centre, Cowley Road,
Cambridge, CB4 0WS
T: 0845 838 33 99
F: 0845 838 33 89
E: technical@isomass.co.uk W: www.isomass.co.uk

