

Isocheck 23C & 14C Systems

overlay platform system for concrete floors

CI/SfB
_____ (43) _____ (Y) _____ (P2)

March 2010

Rev 3

product data sheet

Manufactured with cross linked Isopoli foam

Suitable for: **robust details - new build**

Conversions • Refurbishments • New build

Product data

Overall size:	Isocheck 23C	2400mm x 600mm x 23mm
	Isocheck 14C	1200mm x 600mm x 14mm
Resilient layer:		5.5mm Isopoli cross linked foam
Weight:	Isocheck 23C	18.8kg per sheet
	Isocheck 14C	5.15kg per sheet

Performance (on the construction below top)

Treated floor with:	$D_{nT,w} + C_{tr}$	$L'_{nT,w}$
Isocheck 23C	53dB	53dB
Isocheck 14C	51dB	52dB

Complies with Robust Detail descriptive FFT5 within E-FC-1, E-FC-2 and E-FS-1.

Description

Isocheck 23C & 14C systems are designed to reduce sound transmission and also reduce impact sound transmission through concrete floors.

Isocheck 23C consists of a 5.5 mm layer of cross linked Isopoli bonded to 18mm P5 V313 moisture resistant chipboard, whereas Isocheck 14C consists of a 5.5 mm layer of cross-linked Isopoli bonded to 9mm moisture resistant medium density fibreboard. When installed as part of a complete party floor construction either system enables a concrete floor to meet the sound transmission standards of ADE 2003 (amended 2004).

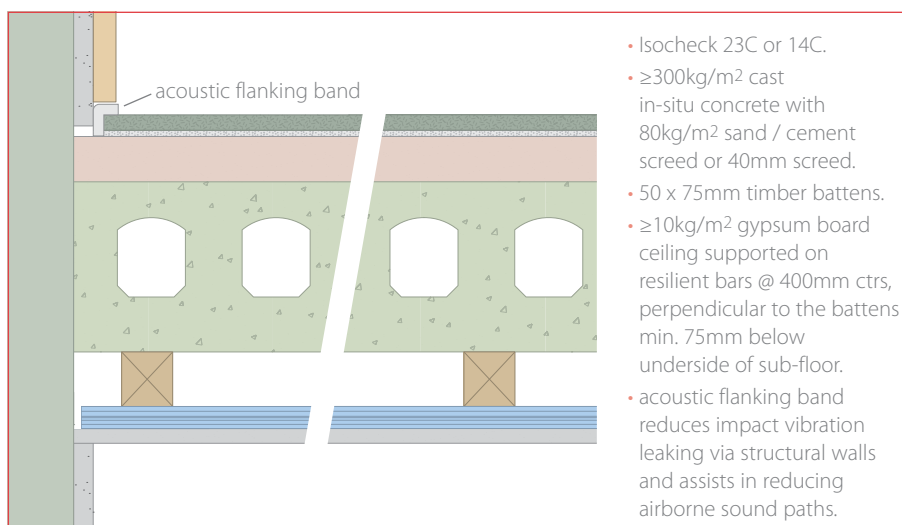
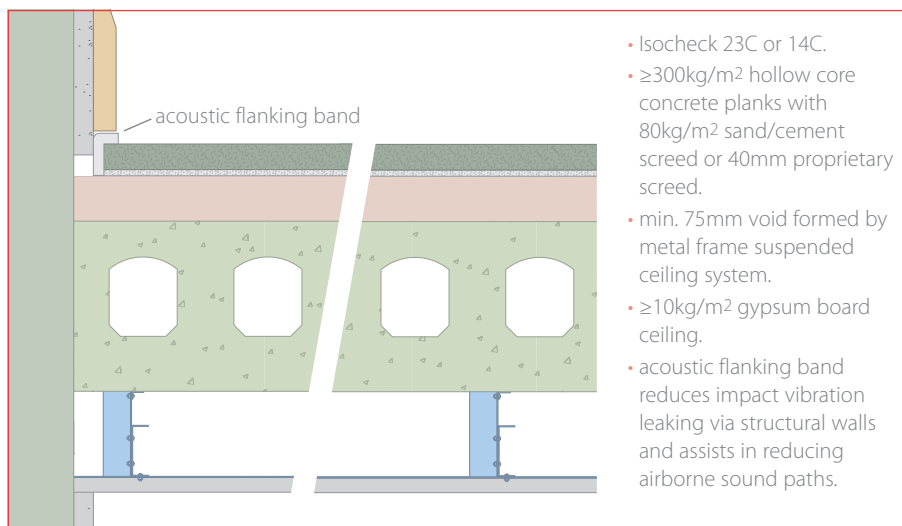

Every effort has been taken in the preparation of this sheet to ensure the accuracy of representations contained herein. Recommendations as to the use of materials, construction details and methods of installation are given in good faith and relate to typical situations. However, every site has different characteristics and reliance should not be placed upon the foregoing recommendations. Advice can be given as to specific applications.

Specification

The acoustic floor shall be:

- **Isocheck 23C or 14C system**, manufactured by Isomass Ltd. St Johns Innovation Centre, Cowley Road, Cambridge, CB4 0WS and installed in accordance with manufacturer's instructions / recommendations.

Installation

- Lay Isocheck Deck 23C or 14C over dry level screed, in brick bond pattern, applying Isocheck adhesive to all tongued and grooved panel joints.
- Apply Isocheck Acoustic Angled Flanking Band on the edges of the Isocheck boards just before they are pushed against the perimeter walls to isolate the board from the wall.
- Install skirting and trim off excess Flanking Band.
- Full installation instructions are available and must be used in conjunction when laying this floating floor system.

For advice on treatment of services and penetrations, consult our brochure or visit our website:

www.isomass.co.uk

Technical enquiries

Tel: **0845 838 33 99**

Fax: **0845 838 33 89**

Email: info@isomass.co.uk

**isomass**[®]
building acoustics

**NHBC**
TESTED BY NHBC
ACOUSTIC SERVICES

