

Isocheck Cradle System

suspended system for uneven concrete floors

Manufactured with reconstituted Isolate C

Suitable for: **robust details - new build** • **E1 - new build** • **E1 - material change of use**

Conversions • New build • In conjunction with underfloor heating systems

product data sheet

Product data

Overall size:	97mm x 97mm x 43.5mm
Height of base plate:	11mm
Resilient layer:	Isolate C

Various options of Cradle are available including deep, shallow and for underfloor heating systems.

Performance (on the two Robust Detail constructions below)

Treated floor meets with the Robust Detail descriptive FFT2, typically within Robust Details E-FC-1, E-FS-1, E-FC-2 and E-FC-7. Two typical alternative constructions are shown below.

Description

Isocheck Cradle system is designed to reduce sound transmission through concrete floors. Isocheck Cradle consists of a 10 mm layer of Isolate C bonded to an injection moulded plastic cradle. The system includes levelling packers in various thicknesses as well as elevating blocks where extra height is required.

When installed as part of a complete party floor construction this system enables a concrete floor to meet the sound transmission standards of ADE 2003 (amended 2004).

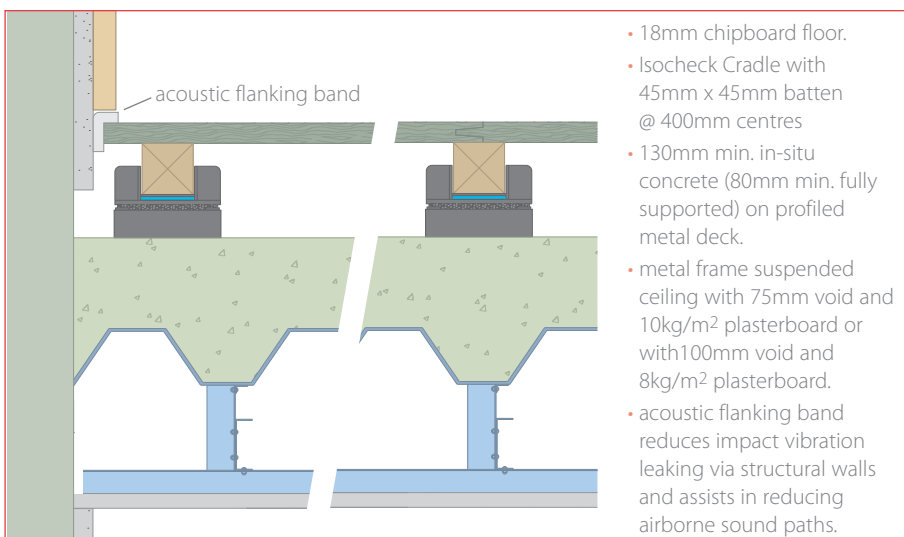
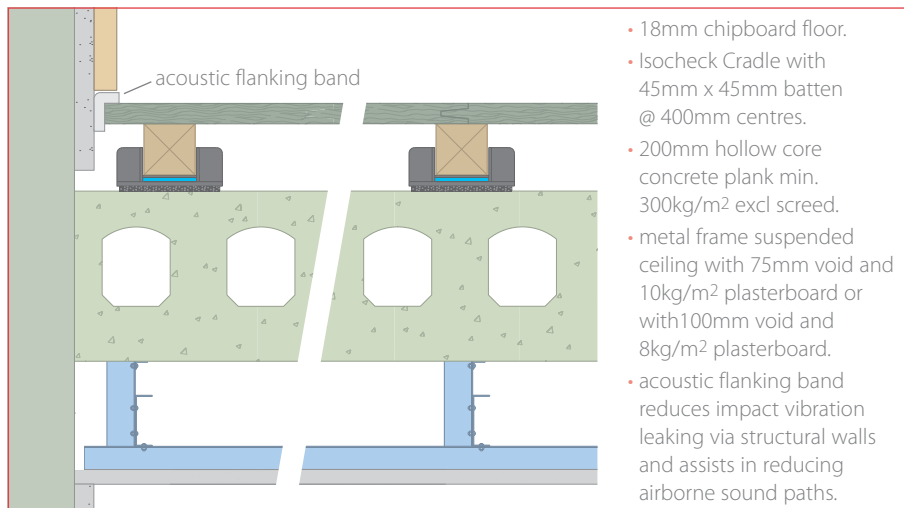

Every effort has been taken in the preparation of this sheet to ensure the accuracy of representations contained herein. Recommendations as to the use of materials, construction details and methods of installation are given in good faith and relate to typical situations. However, every site has different characteristics and reliance should not be placed upon the foregoing recommendations. Advice can be given as to specific applications.

Specification

The acoustic floor shall be:

- **Isocheck Cradle system** (complete with levelling packers), by Isomass Ltd. St Johns Innovation Centre, Cowley Road, Cambridge, CB4 0WS and installed in accordance with manufacturer's instructions / recommendations.

Installation

- Lay Isocheck Cradle with 18mm or 22mm chipboard deck in brick bond pattern on timber battens (preferably stress graded) with all joints supported, applying adhesive to all tongued and grooved panel joints.
- Apply Isocheck Acoustic Angled Flanking Band on the edges of the chipboard just before they are pushed against the perimeter walls to isolate the board from the wall.
- Install skirting and trim off excess Flanking Band.
- Full installation instructions are available and must be used in conjunction when laying this floating floor system.

For advice on treatment of services and penetrations, consult our brochure or visit our website:

www.isomass.co.uk

Technical enquiries

Tel: **0845 838 33 99**

Fax: **0845 838 33 89**

Email: info@isomass.co.uk