

# Isocheck Impact Mat 100, 200 & 300

impact (100) and impact/airborne improvement (200 & 300) systems for timber floors

CI/SfB  
(43) (Y) (P2)

October 2011

Rev 5.1

Manufactured with Densbak composite, Isolate M or Isopoli

Suitable for: domestic noise issues

Timber floors and staircases for conversions, refurbishments and new build.

## product data sheet

### Product data

Overall size:	Mat 100	1.37m x 7.3m long
	Mat 200	1.20m x 1.0m long
	Mat 300	1.20m x 0.6m long
Resilient layer:	Mat 100	5.5mm Isolate M
	Mat 200	8.0mm Densbak composite
	Mat 300	12.0mm tri-layer with Isopoli core
Weight:	Mat 100	2.2kg/m <sup>2</sup>
	Mat 200	10.0kg/m <sup>2</sup>
	Mat 300	12.5kg/m <sup>2</sup>

### Performance

Laboratory performance of Isocheck Impact Mat 100, 200 & 300 achieved 25dB, 26dB & 40dB  $\Delta L_w$  respectively. When installed beneath a timber floor but on top of a timber sub-floor they improved the impact result  $L'_{nT,w}$  upwards from 4dB depending on the structural sub floor.

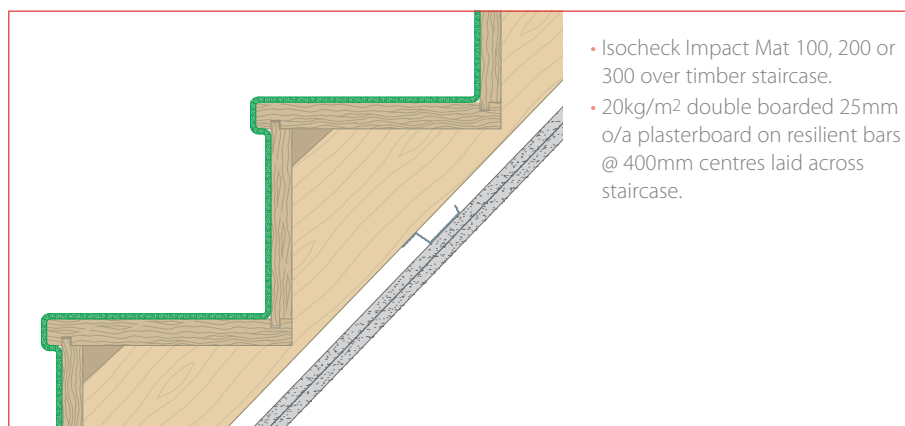
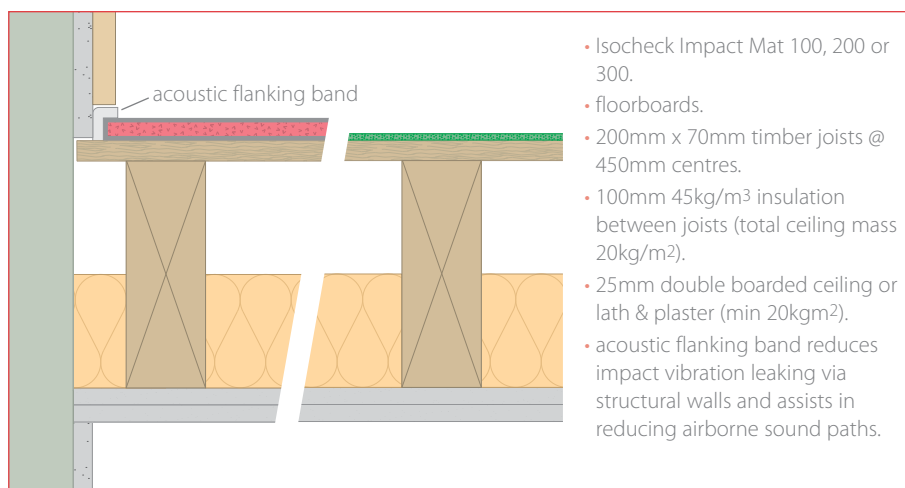

Every effort has been taken in the preparation of this sheet to ensure the accuracy of representations contained herein. Recommendations as to the use of materials, construction details and methods of installation are given in good faith and relate to typical situations. However, every site has different characteristics and reliance should not be placed upon the foregoing recommendations. Advice can be given as to specific applications.

### Description

Isocheck Impact Mat systems are designed to reduce impact sound transmission through timber floors and staircases.

Isocheck Impact Mat consists of 5.5mm, 8mm Densbak composite or 12mm tri-layer system with an Isopoli core. When installed as part of a complete party floor construction it enables a timber floor to meet the sound transmission standards of ADE 2003 (amended 2004).

### Specification

The acoustic floor shall be:

- **Isocheck Impact Mat system**, supplied by Isomass Ltd. St Johns Innovation Centre, Cowley Road, Cambridge, CB4 0WS and installed in accordance with manufacturer's instructions / recommendations.

### Installation

- Lay Isocheck Impact Mat 100, 200 or 300 over the entire level floor with all joints butted.
- Most t&g or interlocking laminate panel floor finishes can be laid directly onto isocheck Impact Mat 100, 200 or 300. If in doubt please contact us with the floor specification.
- Finished timber floors should be isolated from the skirting using Isocheck Acoustic Flanking Band.
- Full installation instructions are available and must be used in conjunction when laying this floating floor system.

For advice on treatment of services and penetrations, consult our brochure or visit our website:

[www.isomass.co.uk](http://www.isomass.co.uk)

### Technical enquiries

Tel: **0845 838 33 99**

Fax: **0845 838 33 89**

Email: [info@isomass.co.uk](mailto:info@isomass.co.uk)