

Isocheck Maximo System

direct to joists system

Manufactured with fire rated Isolate FR foam plus isofiba

Suitable for: E1 - material change of use

Conversions • Refurbishments • New build • Listed buildings requiring minimal structural change

product data sheet

Product data

Overall size:	2400mm x 600mm x 37mm
Resilient layer thickness:	15mm
Resilient layer:	10mm Isolate FR: class 1 plus 5mm Isofiba
Weight:	23.8kg per sheet

Performance (on the construction below)

Treated floor with:	$D_{nT,w} + C_{tr}$	$L'_{nT,w}$
Isocheck 37T with boarded ceiling	45dB	60dB

Decorative, oak effect, hard-wearing, weatherproof, anti-slip phenolic finish

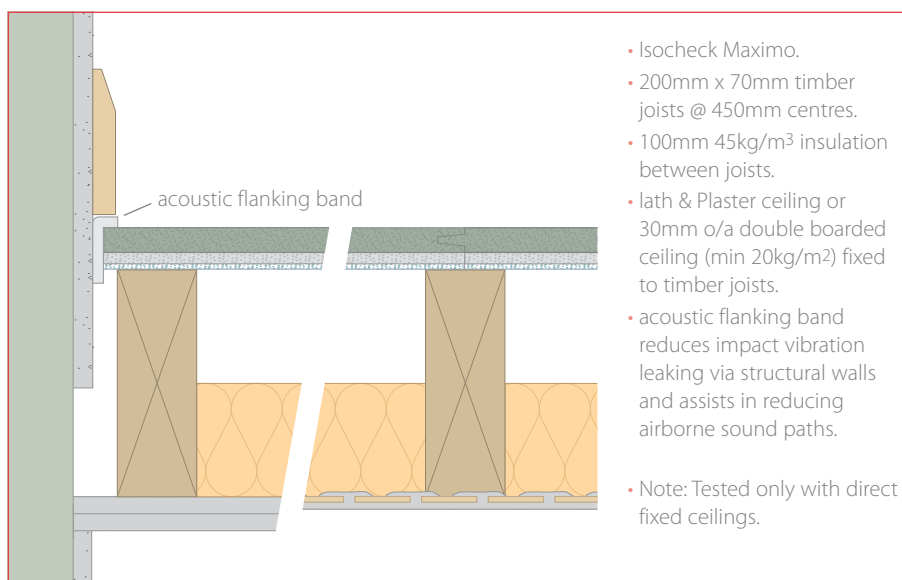

Every effort has been taken in the preparation of this sheet to ensure the accuracy of representations contained herein. Recommendations as to the use of materials, construction details and methods of installation are given in good faith and relate to typical situations. However, every site has different characteristics and reliance should not be placed upon the foregoing recommendations. Advice can be given as to specific applications.

Description

The Isocheck Maximo system is designed to replace floorboards and reduce sound transmission whilst thermally enhancing traditional joisted timber floors.

Isocheck Maximo consists of a unique combination of a 10mm fire and thermally rated Isolate FR resilient layer and the added isolation of a 5mm isofibre layer, bonded to 22mm P5 V313 moisture resistant chipboard with a decorative, oak effect, hard-wearing, anti-slip phenolic finish.

When installed as part of a complete party floor, this system enables a traditional timber joisted floor to meet the sound insulation standards of ADE 2003 (amended 2004).

Specification

The acoustic floor shall be:

- **Isocheck Maximo system**, manufactured by Isomass Ltd. St Johns Innovation Centre, Cowley Road, Cambridge, CB4 0WS and installed in accordance with manufacturer's instructions / recommendations.

Installation

- Lay Isocheck Maximo directly to the timber joists, in brick bond pattern, applying Isocheck adhesive to all tongued and grooved panel joints.
- Apply Isocheck Angled Acoustic Flanking Band on the edges of the Maximo boards just before they are pushed against the perimeter walls to isolate the board from the wall.
- Install skirting and trim off excess Flanking Band.
- Full installation instructions are available and must be used in conjunction when laying this floating floor system.

For advice on treatment of services and penetrations, consult our brochure or visit our website:

www.isomass.co.uk

Technical enquiries

Tel: 0845 838 33 99

Fax: 0845 838 33 89

Email: info@isomass.co.uk